



TA Relay



Features

- ultraminiature relay, 12.5 × 7.5 × 10 mm (L × W × H)
- ultra high sensitivity, 150 mW nom. coil power consumption
- 2.54 mm terminal pitch

Contact Data

Contact Arrangement	1 Form C
Contact Material.....	Ag alloy with gold overlay
Contact Rating	1 A / 30 VDC 0,5 A / 125 VAC
Switching current max.	2A
Switching voltage max.	60 VDC / 125 VAC
Switching power max.....	30 W / 62,5 VA
Initial Contact Resistance max.	100 mohms
Min. Switching power.....	1 mA / 5 VDC

General Data

Insulation Resistance min.....	1000 Mohms (at 500 VDC)
Dielectric Strength	400 VAC 1 minute (between open contacts) 1000 VAC 1 minute (between coil and contacts)
Operate Time	5 ms
Release Time	5 ms
Ambient Temperature.....	-30 to +85°C (no frost)
Shock Resistance.....	10 G
Vibration Resistance.....	10 to 55 Hz at double amplitude of 3,3 mm
Life Expectancy	Mechanical 1 × 10 ⁷ ope. min. Electrical 1 × 10 ⁵ ope. min.
Weight	Approx. 2,2 gs

Coil Table

Nominal Voltage VDC	Coil Resistance (Ohm) +/- 10% at 20°C	Operate Voltage (VDC) at 20°C (max.)	Release Voltage (VDC) at 20°C (min.)	Nominal Coil Power (mW)
1,5 V	15	1,2	0,15	150
03 V	60	2,4	0,3	150
05 V	167	4	0,5	150
06 V	240	4,8	0,6	150
09 V	540	7,2	0,9	150
12 V	960	9,6	1,2	150
24 V	3840	19,2	2,4	150



Ordering Information: TA / 12 - LF

Nominal Coil Voltage
Refer to coil table

Coil-type
Nil: Standard
LF: Lead free type

Dimensions [in mm]

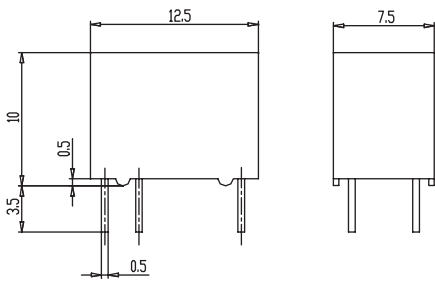

Wiring Diagram [bottom view]

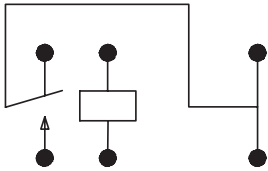

PC Board Layout [bottom view]

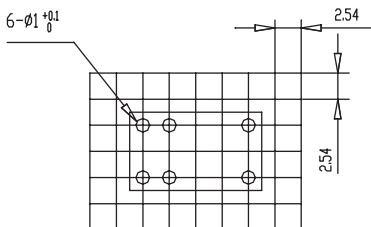

Useful Curves

Contact Switching Capacity

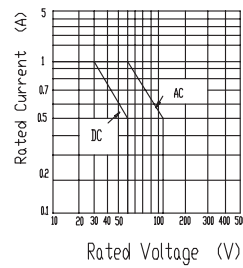

Contact Life

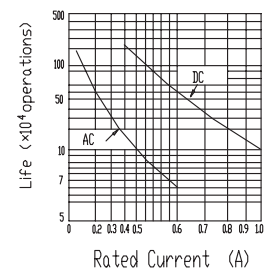

Ambient temperature

